

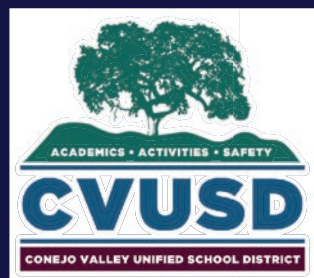

CVUSD | *Facilities Master Plan*



CVUSD - NEWBURY PARK CLUSTER



Maple Elementary | *Alternate Concepts*

3501 Kimber Dr, Newbury Park, CA 91320
Conejo Valley Unified School District
April 5, 2017

NAC Architecture
837 North Spring Street, 3rd Floor
Los Angeles, CA 90012
Contact: 323.475.8075
E-mail: lochoa@nacarchitecture.com
Website: www.nacarchitecture.com



Challenges Summary:

- Building layout creates supervision concerns
- Lack of administration space
- Congestion at parking lot/drop-off
- Typical Accessibility challenges

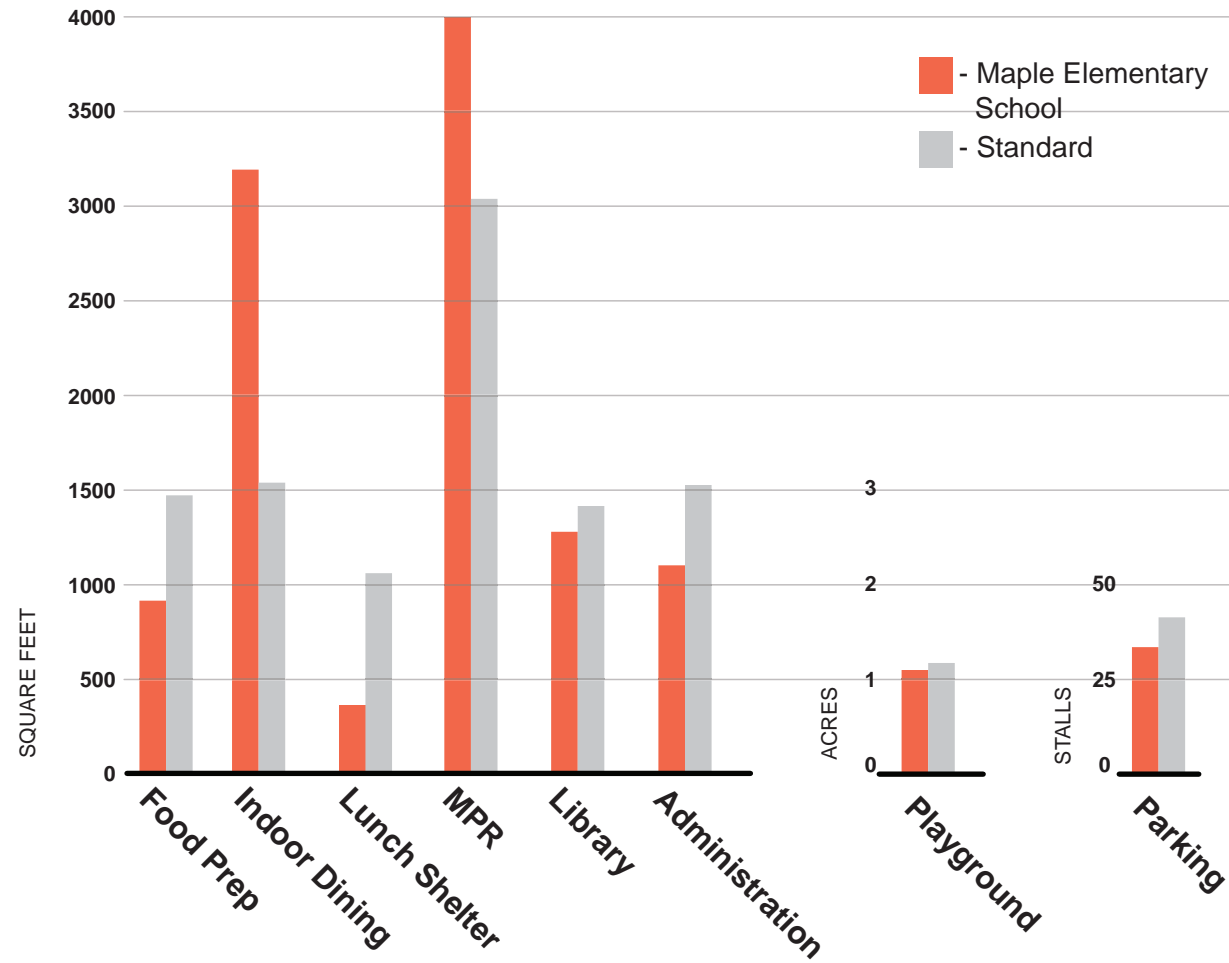

Core Facilities Summary

Current facilities meet school's needs

- Food Prep (-595 SF)
- Indoor Dining (+1,840 SF)
- Multi-Purpose Room (+980 SF)
- Playground (-0.18 Acres)

Current facilities DO NOT meet school's needs

- Lunch Shelter (-772 SF)
- Administration (-236 SF)
- Library (-3 SF)
- Parking (-4 Stalls)

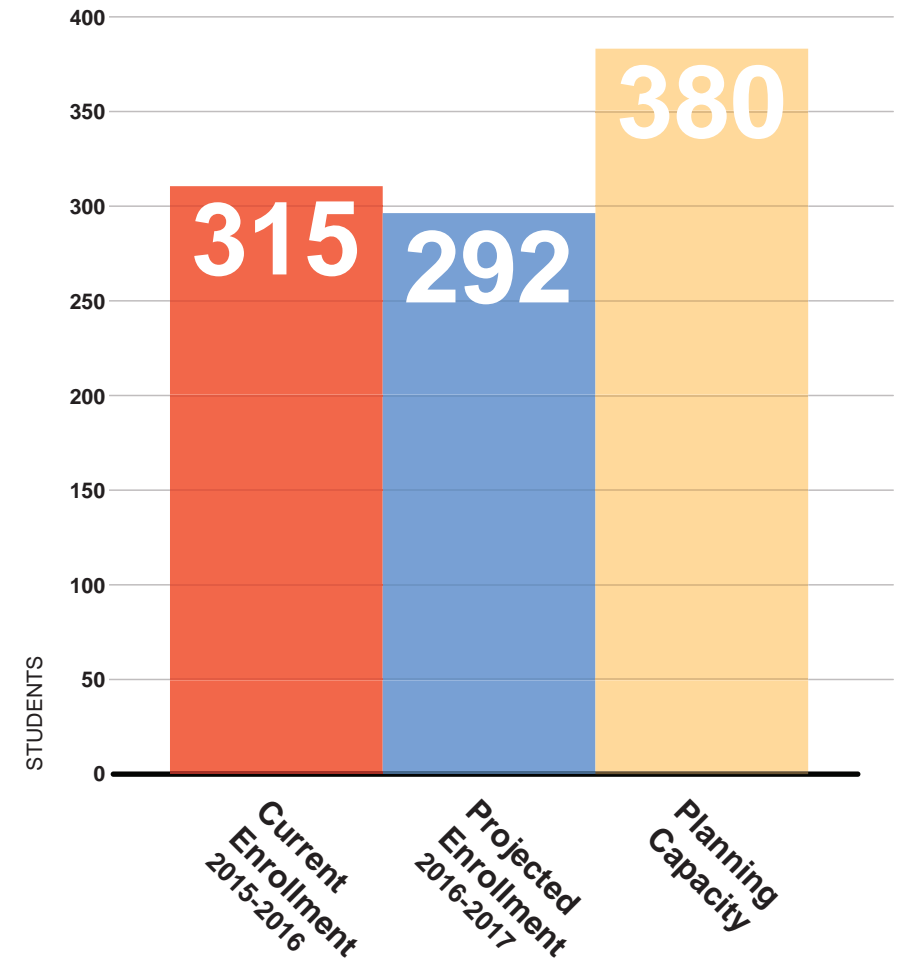

Enrollment Summary

Total Current Classrooms: 20
 Total Based on Projected Enrollment Classrooms: 18

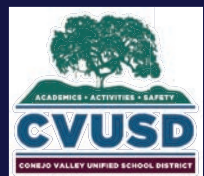

LEGEND

- Existing Building (No Work)
- New Construction
- High Modernization
- Medium Modernization
- Low Modernization
- Structure Above
- x Building Number
- "P" Indicates Portable
- x Indicates Uncertified

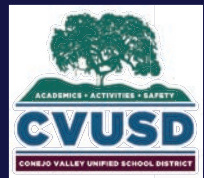
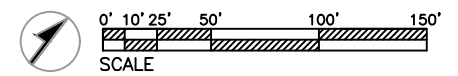

Maple Elementary | Alternate Concepts

3501 Kimber Drive, Newbury Park, CA 91320
Conejo Valley Unified School District
April 5, 2017

Existing Conditions

LEGEND

- Existing Building (No Work)
- New Construction
- High Modernization
- Medium Modernization
- Low Modernization
- Structure Above
- x Building Number
- "P" Indicates Portable
- x Indicates Uncertified

CAMPUS-WIDE IMPROVEMENTS

- Resolve condensing unit overheating issues and provide screening
- Provide exterior lighting
- Reconcile non-compliant accessibility conditions

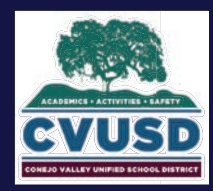
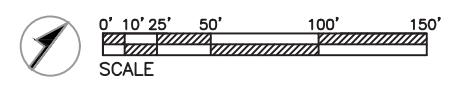
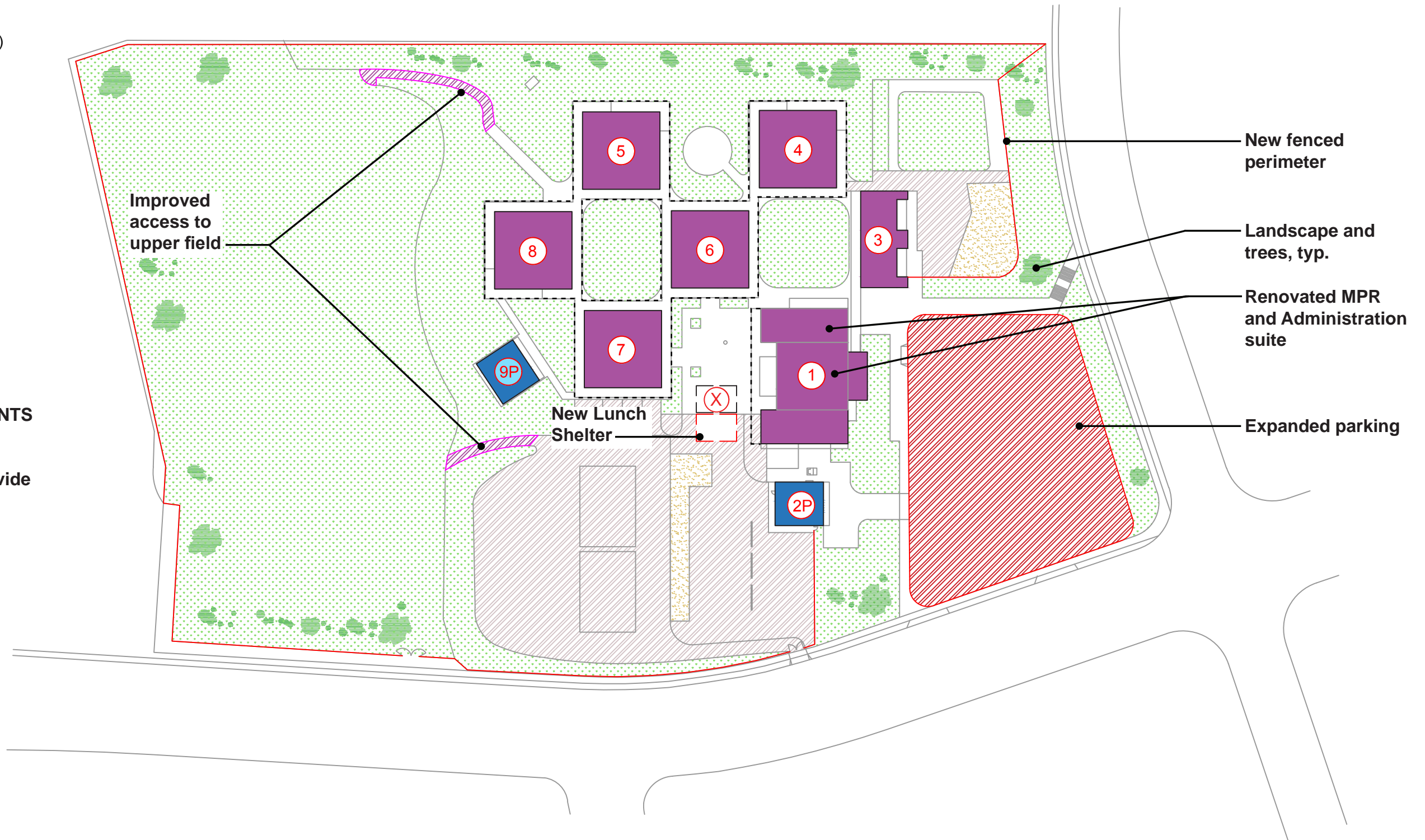

Maple Elementary | *Alternate Concepts*
 3501 Kimber Drive, Newbury Park, CA 91320
 Conejo Valley Unified School District
 April 5, 2017

Alternate Concept 1

LEGEND

- Existing Building (No Work)
- New Construction
- High Modernization
- Medium Modernization
- Low Modernization
- Structure Above
- x Building Number
- "P" Indicates Portable
- x Indicates Uncertified

CAMPUS-WIDE IMPROVEMENTS

- Resolve condensing unit overheating issues and provide screening
- Provide exterior lighting
- Reconcile non-compliant accessibility conditions

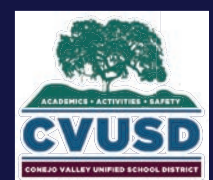
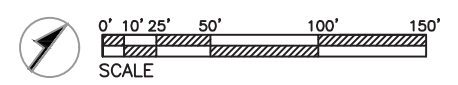
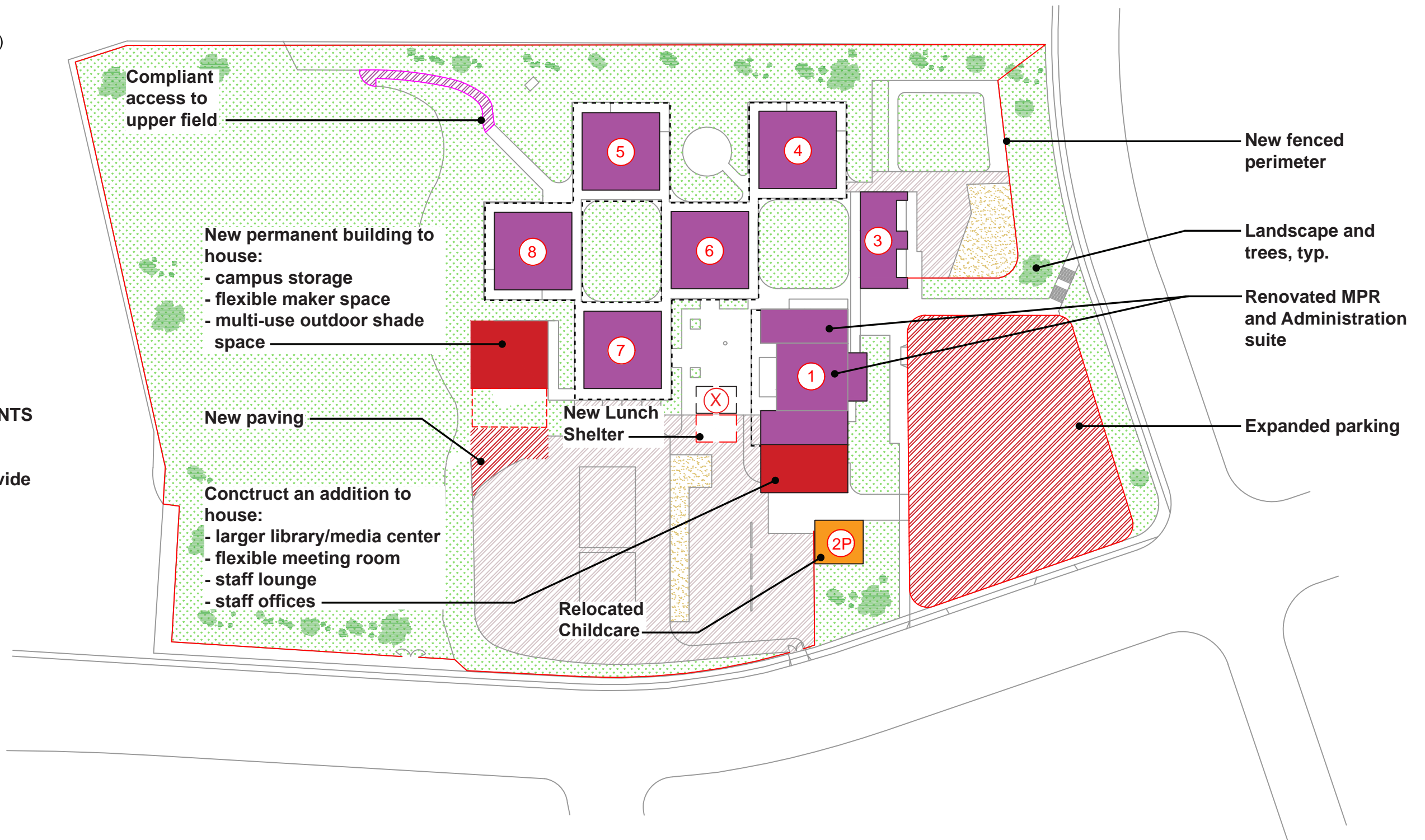

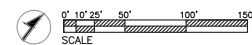
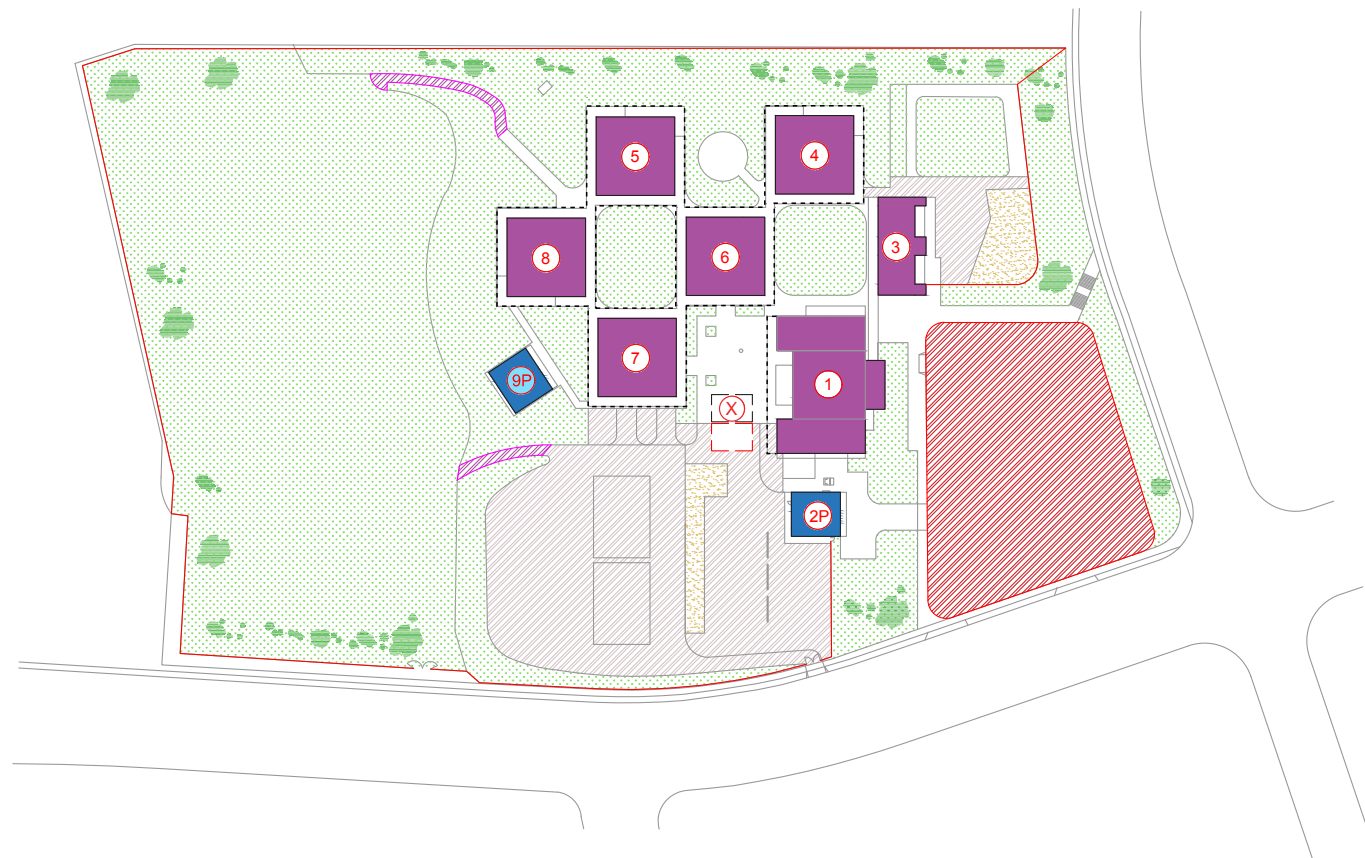

Alternate Concept 1

Project Scope:

- Expand parking and drop-off
- Add shade structures
- Cosmetic Modernization to all buildings
- Additional Lunch Shelter
- Site access/accessibility improvements

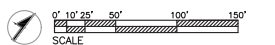

Alternate Concept 2

Project Scope:

- Expand parking and drop-off
- Add shade structures
- Cosmetic Modernization to all buildings
- Additional Lunch Shelter
- Site access/accessibility improvements
- Addition to Building #1
- New Permanent Building
- Relocated Childcare

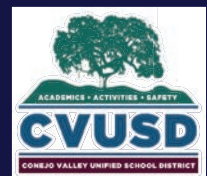

Maple Elementary | *Alternate Concepts*

3501 Kimber Drive, Newbury Park, CA 91320
Conejo Valley Unified School District
April 5, 2017

Summary