

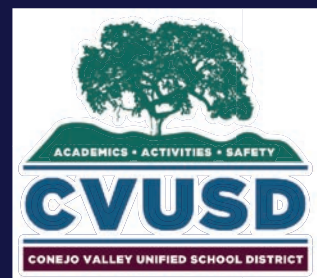

CVUSD | *Facilities Master Plan*

CVUSD - NEWBURY PARK CLUSTER



Newbury Park High | *Alternate Concepts*

456 N Reino Road | Newbury Park, CA 91320
Conejo Valley Unified School District
April 5, 2017

NAC Architecture
837 North Spring Street, 3rd Floor
Los Angeles, CA 90012
Contact: 323.475.8075
E-mail: lochoa@nacarchitecture.com
Website: www.nacarchitecture.com

LEGEND

- Existing Building (No Work)
- New Construction
- High Modernization
- Medium Modernization
- Low Modernization
- Structure Above
- X Building Number
- "P" Indicates Portable
- X Indicates Uncertified

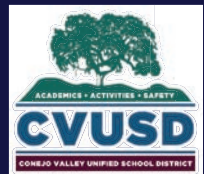
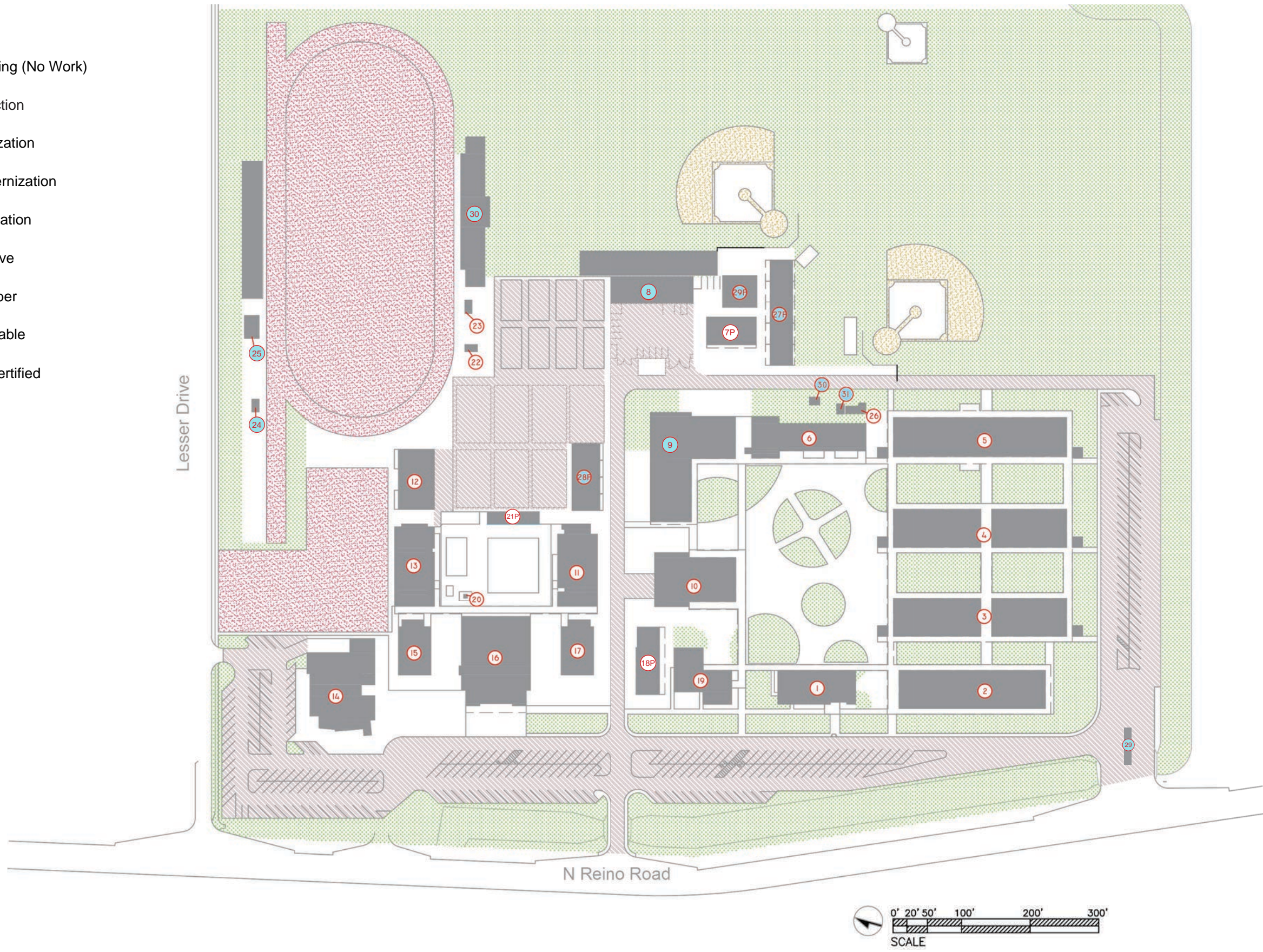

LEGEND

- Existing Building (No Work)
- New Construction
- High Modernization
- Medium Modernization
- Low Modernization
- Structure Above
- X Building Number
- "P" Indicates Portable
- X Indicates Uncertified

CAMPUS-WIDE IMPROVEMENTS

- Improve HVAC, electrical, and domestic water infrastructure
- Provide additional shaded dining
- Address accessibility where needed

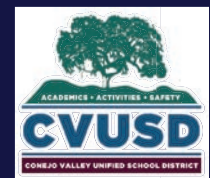
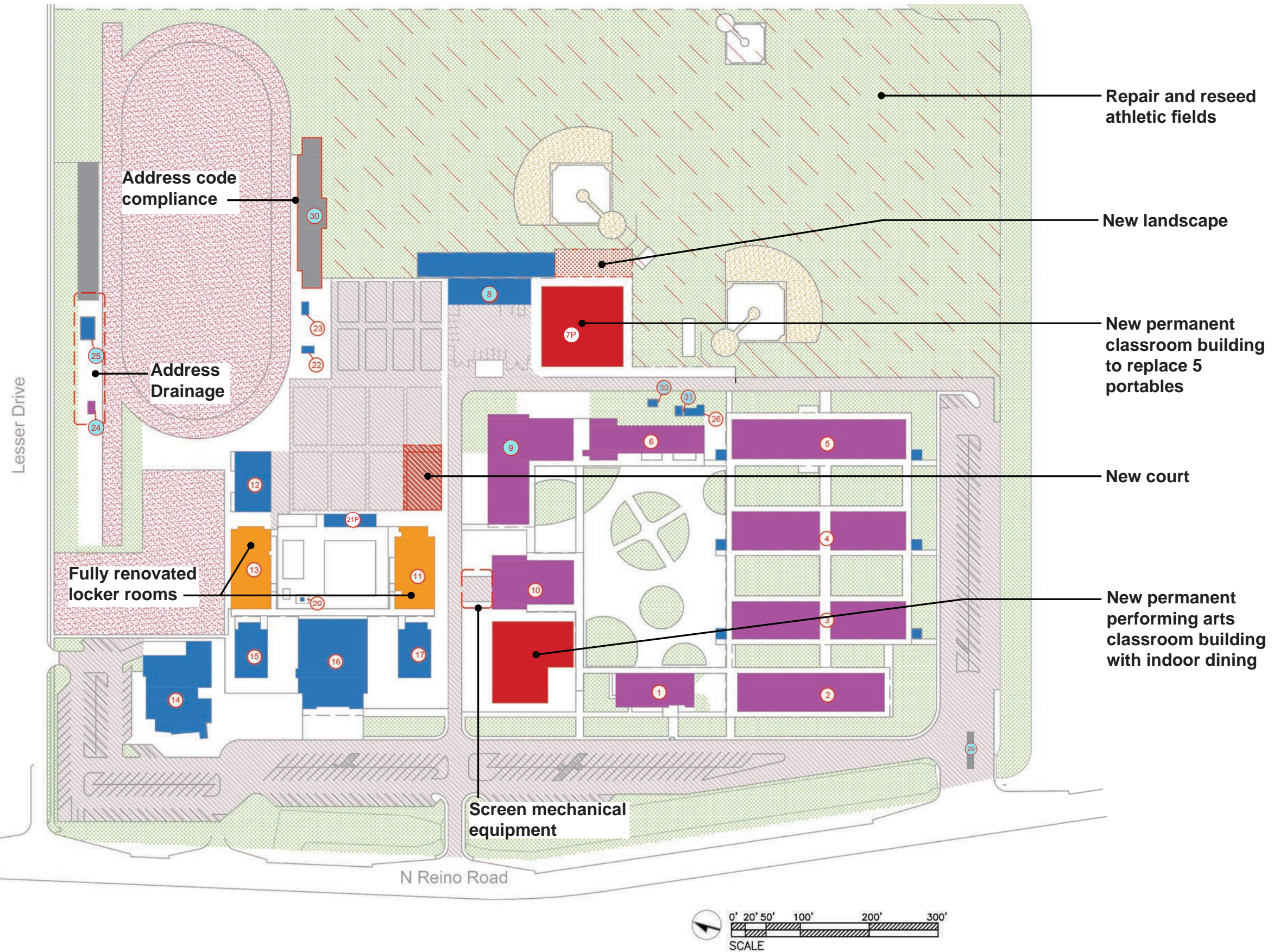

Newbury Park High | *Alternate Concepts*

456 N Reino Road, Newbury Park, CA 91320
 Conejo Valley Unified School District
 April 5, 2017

Alternate Concept 1

LEGEND

- Existing Building (No Work)
- New Construction
- High Modernization
- Medium Modernization
- Low Modernization
- Structure Above
- X Building Number
- "P" Indicates Portable
- X Indicates Uncertified

CAMPUS-WIDE IMPROVEMENTS

- Improve HVAC, electrical, and domestic water infrastructure
- Provide additional shaded dining
- Address accessibility where needed

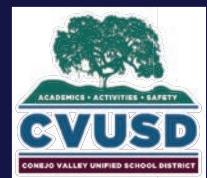
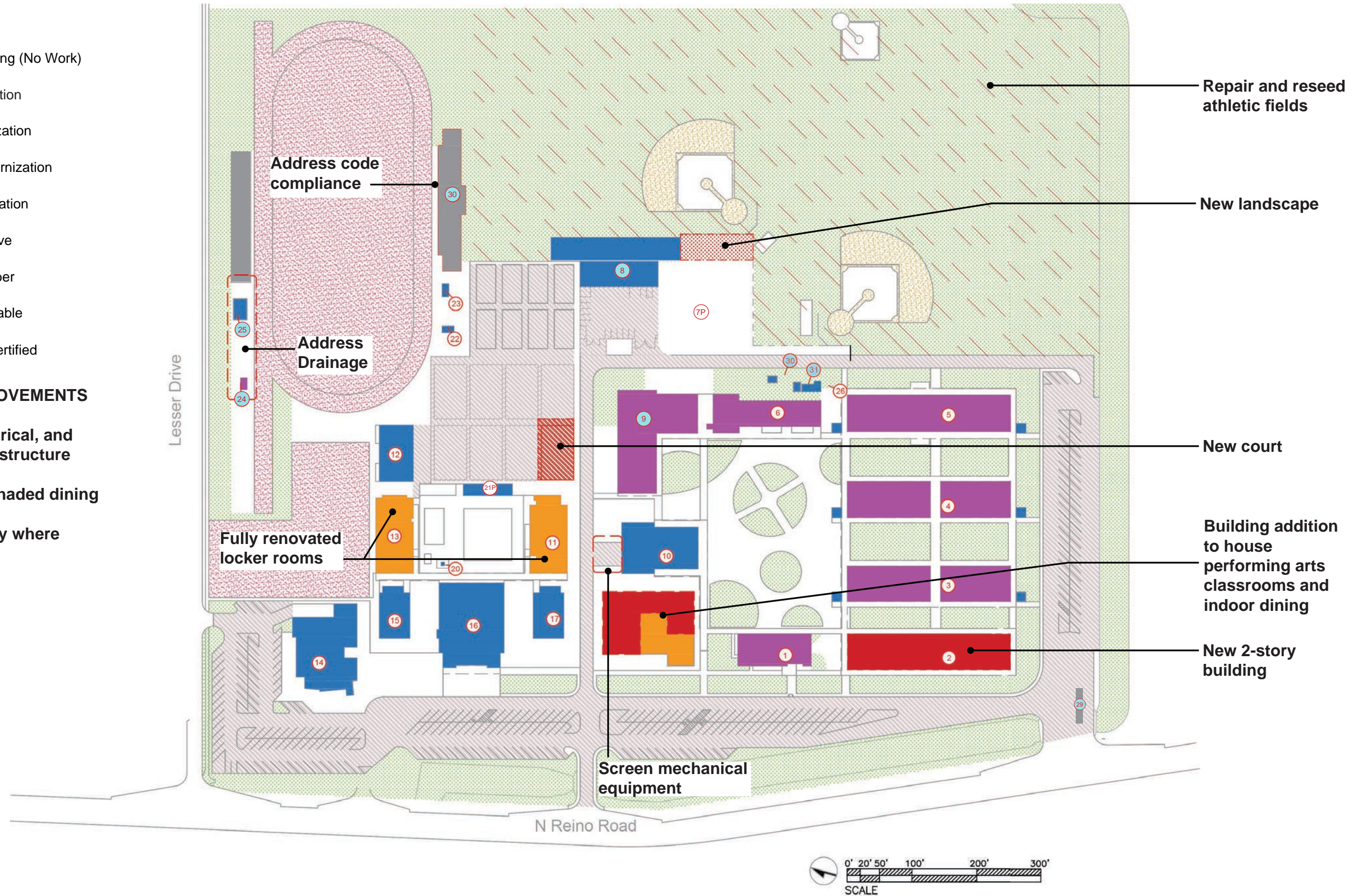

Newbury Park High I *Alternate Concepts*

456 N Reino Road, Newbury Park, CA 91320
 Conejo Valley Unified School District
 April 5, 2017

Alternate Concept 2

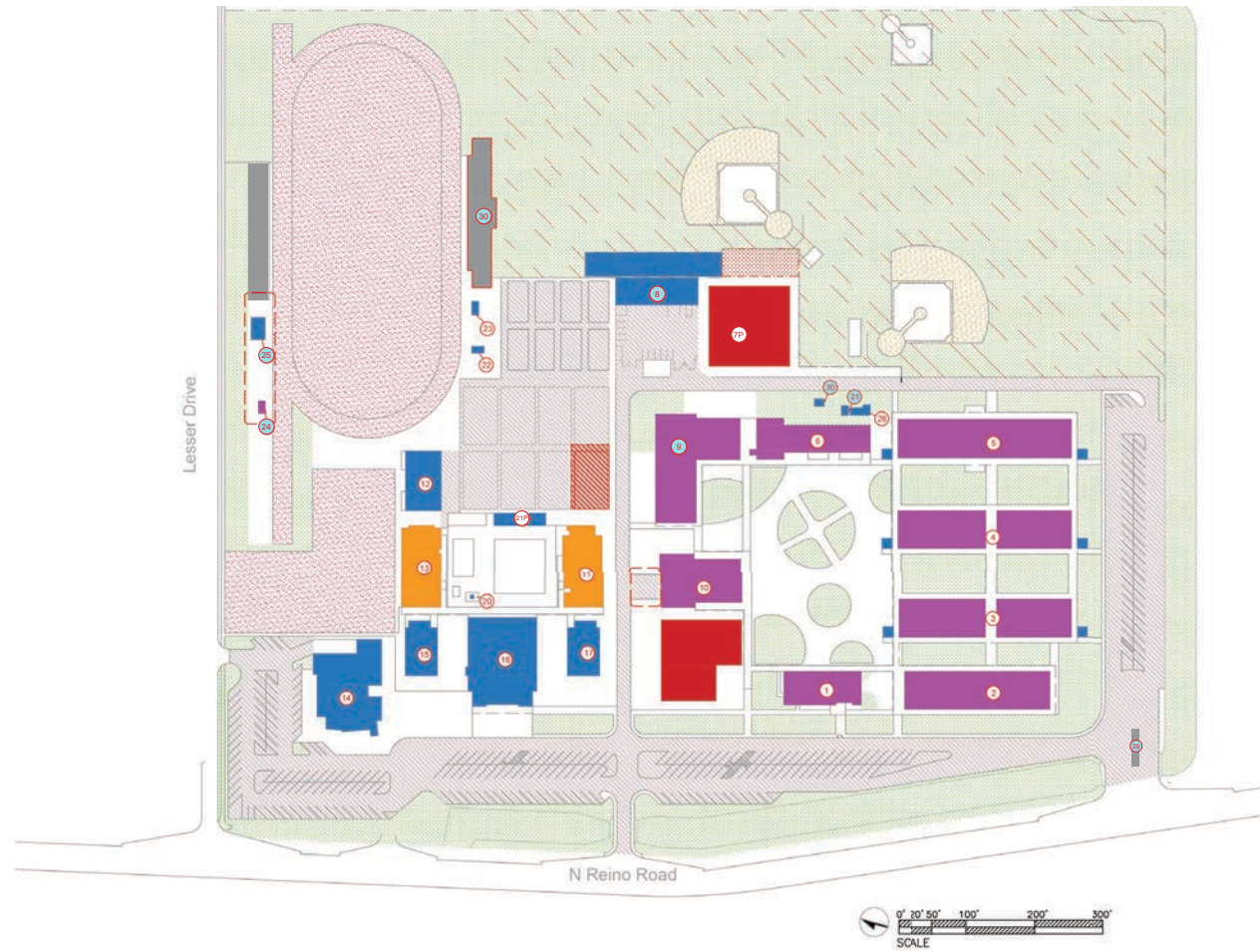

Alternate Concept 1

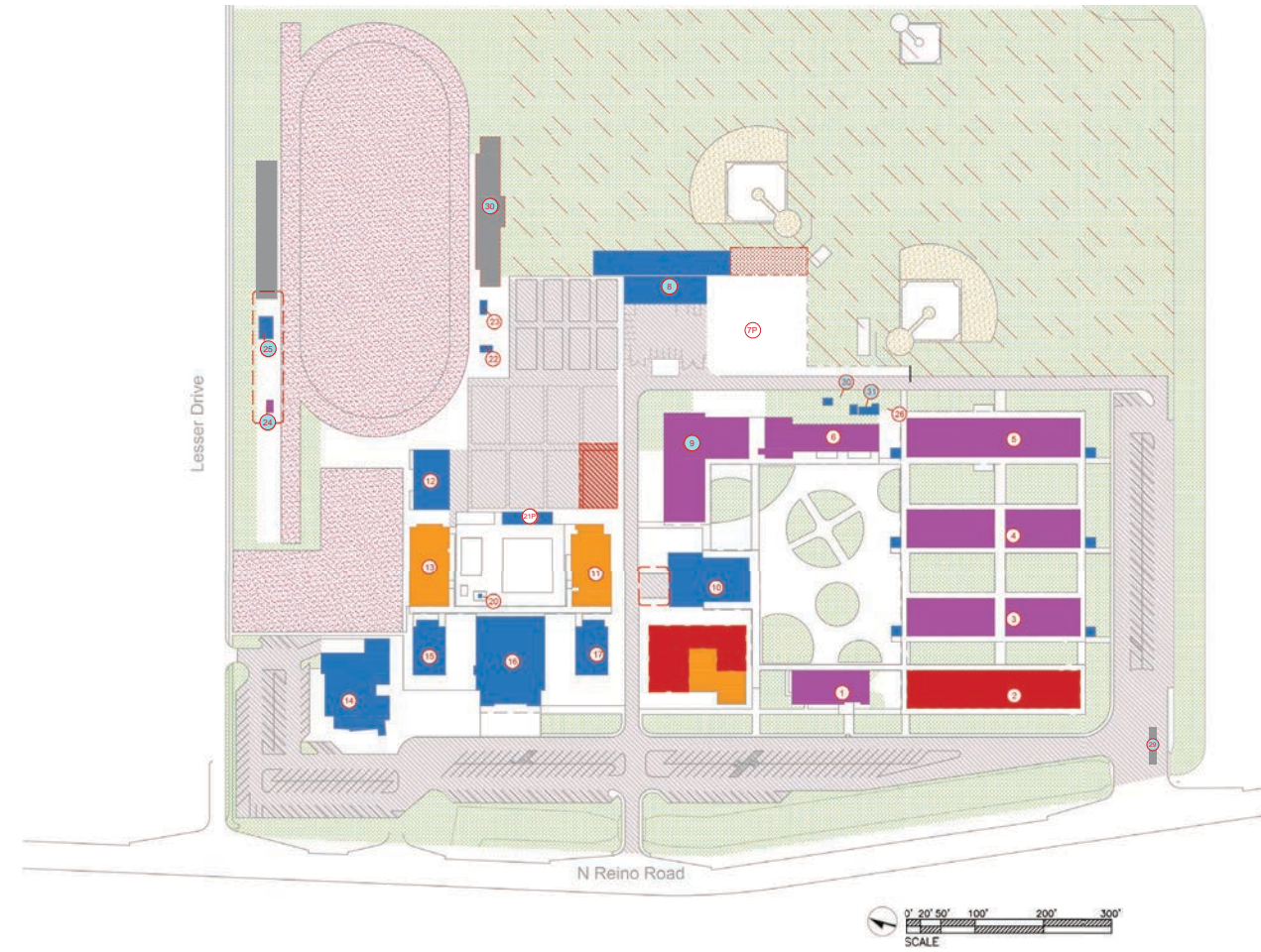

Alternate Concept 2

Project Scope:

- New permanent classroom building to replace 5 portables (7, 18, 27, 28, 29)
- New permanent performing arts classroom building with indoor dining
- Improve HVAC, electrical, and domestic water infrastructure
- Repair and reseed athletic fields
- Fully renovated locker rooms
- Address drainage issues
- Screen mechanical equipment
- Provide additional shaded dining
- Address accessibility where needed

Project Scope:

- Remove portable buildings 7, 18, 27, 28, 29
- Remove Building 2 to construct a new 2-story building
- Building addition to house performing arts classrooms and indoor dining
- Improve HVAC, electrical, and domestic water infrastructure
- Repair and reseed athletic fields
- Fully renovated locker rooms
- Address drainage issues
- Screen mechanical equipment
- Provide additional shaded dining
- Address accessibility where needed

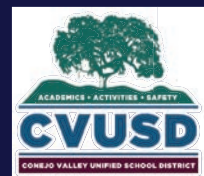

Newbury Park High | Alternate Concepts

456 N Reino Road, Newbury Park, CA 91320
 Conejo Valley Unified School District
 April 5, 2017

Summary